



Volume 02. Number 08

August 2017

Elwood J Euart Association pleased with progress of works at the museum site

When the Museum’s Project Development Office officially opens this October, it will tick off the lease requirement to commence works at the museum site within 5 years from the date of the lease signing.

This special lease with the Vanuatu Government was signed and registered in 2016.

When completed the museum’s project office will house the current project staff and VSA volunteers who will be starting later this year.

It will also become the centre for those who wish to discuss their support for the museum project as well as others who wish to find out more information about the museum project.

Included inside the office will be a display section to showcase items from our collections, as well as the plans of the museum project to promote the project and to assist in our fundraising efforts.

A similar display setup will also be at the Pekoa International Airport, aiming to open this October together with the 75th Memorial of Captain Elwood J Euart .

Image: The Museum Project Development Office approaching its completion, at the Museum site.



Pacific Pathways donate to the Museum’s Project Development Office



Sue and David Mitchel of [Pacific Pathways](#) have generously donated shelves for the Museum’s Project Development Office. The shelves will be used to store items from the museum’s collections as it progresses through its development stages. The Elwood J Euart Association thanks Sue, David and all partners of Pacific Pathways for their generous support and assistance. Pacific Pathways have been supporting education in Vanuatu since 2010. The South Pacific WWII Museum will not only be a world class museum but also an educational complex on Espiritu Santo to inform, exhibit, preserve, educate and facilitate through the provision of meaningful museum services.

We are looking for accounting support

The Museum’s Business & Strategic Plan, currently in development, requires the input from a qualified accountant with experience in developing business financial projections and plans. Please [contact us](#) if this is something you can support the museum with.

Museum Site Layout

To give you some idea of the museum site location, we've overlaid our architect's building plan on top of the satellite image of the area. The labels on the map below are the corresponding reference of how the architect's renderings will look from those angles.



Artwork: James Carter

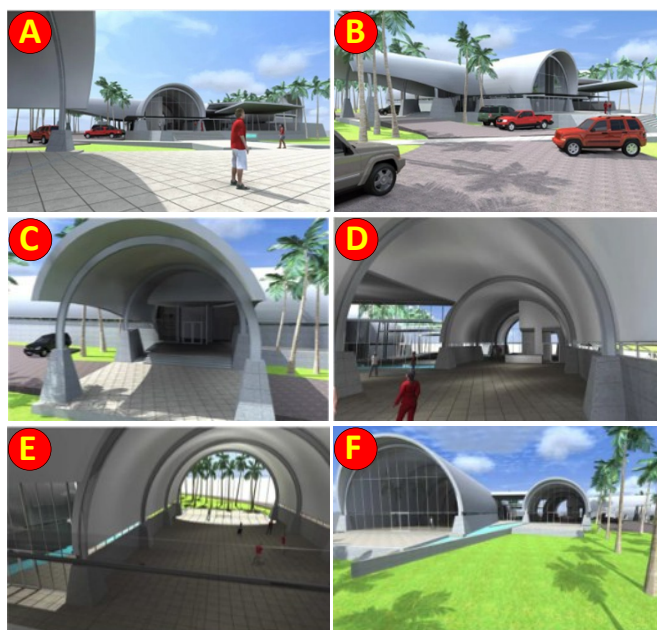

Battle of Guadalcanal—75th Anniversary

Earlier in August, Solomon Islands commemorated the Coastwatchers and 75th Anniversary of the Battle of Guadalcanal, from the 5th of August to the 9th of August, to mark the landing of US Marines on Guadalcanal during World War II.

A series of activities were organized and attended by a large number of visitors, history enthusiasts, researchers, military personnel, government representatives, including reps from the US embassy and the Australian High Commission.

For many, it was to commemorate those who lost their lives, but for two war veterans it was a return full of memories of where it all happened 75 years ago.

Among the remembrance and various other memorial services with unveiling of monuments and plaques, was the Solomon Island Government's declaration of the Bloody Ridge as a National Park and the launch of the new Coastwatchers' Museum project.

The Battle of Guadalcanal, codenamed Operation Watchtower, was a military campaign fought between 7 August 1942 and 9 February 1943 on and around the island of Guadalcanal in the Pacific theatre of World War II. Throughout this period, Espiritu Santo, was the principal supply base to the battles there. Our member Donna Esposito also attended this historical event. *Find out more [here](#).*

Welcome New Members

We are pleased to welcome Peter Wood and Ben Healy to the Elwood J Ewart Association this month. Thank you Peter for also donating your war collections to the museum.

Special Offer to New Members is Still On.

In return of signing up as a member, we'll include your name on a commemorative plaque that will hang in the Museum once construction is complete. This is only for the first 500 members. Sign up today. *Find out more [here](#)*

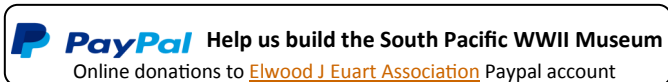

"We aim to inspire all to understand the sacrifice and achievement of others in defending freedom for all"

For more information, donation and pledges of support
CONTACT: Elwood J Ewart Association
Email: info@southpacificwwiimuseum.com
Website: www.southpacificwwiimuseum.com
Phone: (678) 36 227 Fax: (678) 36 829
PO Box 850 Luganville Espiritu Santo Vanuatu